

**TOLERANCE:**  
 $\pm 3/32"$  VERTICAL DIMENSIONS  
 $\pm 1/8"$  HORIZONTAL DIMENSIONS

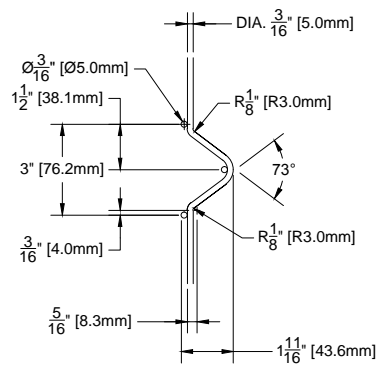

**1 RIB DETAIL**  
 SCALE: NTS

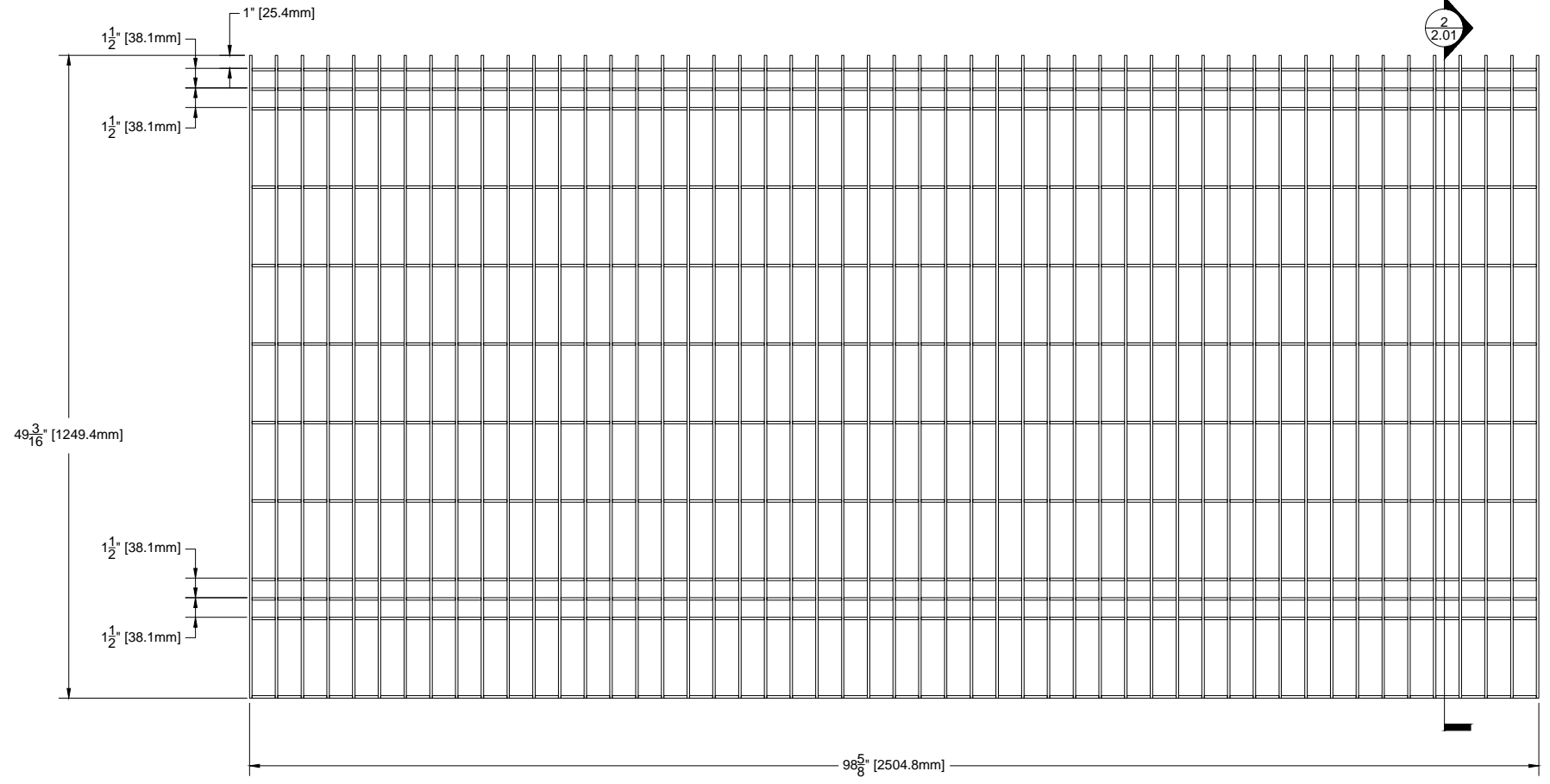

**TOLERANCE:**  
 $\pm 3/32"$  VERTICAL DIMENSIONS  
 $\pm 1/8"$  HORIZONTAL DIMENSIONS

**NIBS:**  
 $1/4"$  NIBS ARE ACCEPTABLE

**3 8'W x 4'H PRISM PANEL ELEVATION-AFTER BENDING**  
 SCALE: NTS

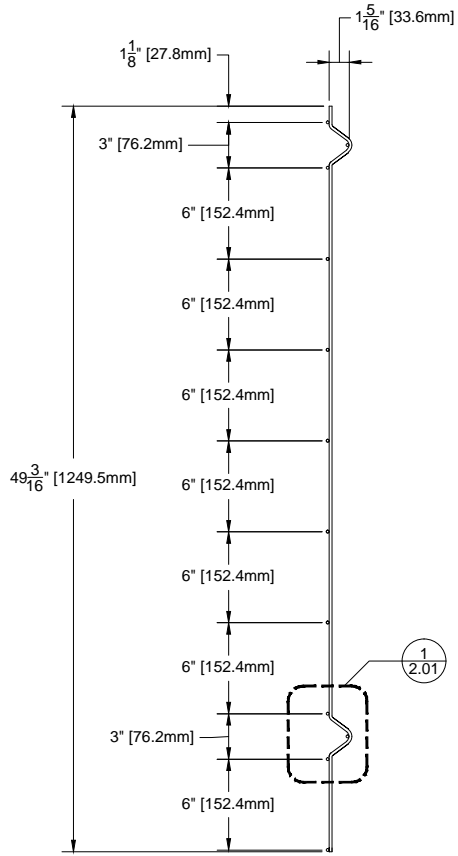

**2 SECTION**  
 SCALE: NTS

SAP Part Numbers		
Procedure	Color	SAP Number
Cut	N/A	4029069
Weld	N/A	4028638
Paint	Black	7064874
Assembly	Black	-
Paint	-	-
Assembly	-	-

REVISION	DATE	DESCRIPTION	BY	APPROVED

<b>MATERIAL SPECIFICATIONS:</b> TUBE STEEL - AS500 Grade B PLATE, ANGLE & CHANNEL - A36 Steel ALL WIRE - COMMERCIAL GALV. TYP. U.N.O. FINISH: SEE CHART ABOVE		SCALE: N/A
		DRAWN: DT
TOLERANCES FRACTIONS $\pm 1/16"$ .XX .032 .XXX .016 ANGLE $6^\circ$ UNLESS OTHERWISE NOTED ON DRAWING		CHECKED: RN
DESCRIPTION: <b>8'Wx4'H PRISM 2X6          PANEL- AFTER BEND</b>		DATE: 06/14/16
DRAWING NUMBER: <b>PRM33P101900</b>		PART NUMBER: SEE CHART

**NOTICE:** BETAFENCE USA CLAIMS PROPRIETARY RIGHTS TO ALL INFORMATION AND/OR TECHNICAL DATA CONTAINED ON THIS DRAWING WHICH IS TO BE MAINTAINED BY YOU IN STRICT CONFIDENCE. THIS DRAWING IS NOT TO BE DISCLOSED OR REPRODUCED, IN WHOLE OR IN PART, DIRECTLY OR INDIRECTLY, IN ANY MANNER WHATSOEVER, WITHOUT THE EXPRESS WRITTEN CONSENT OF BETAFENCE USA, AND IT SHALL BE RETURNED UPON REQUEST.